

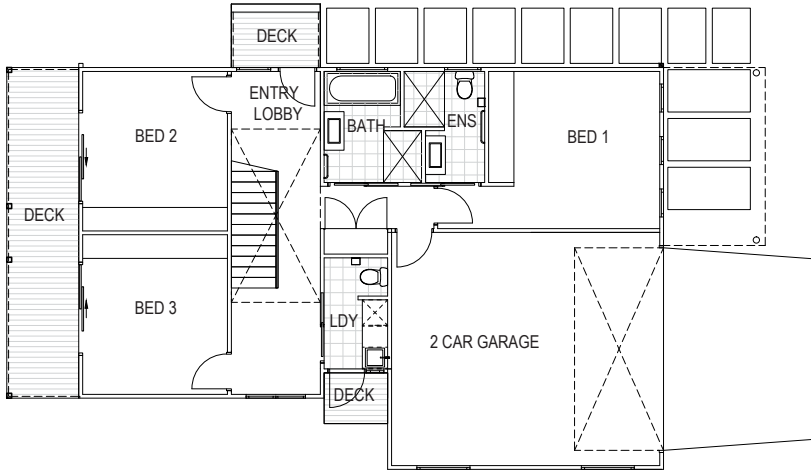

**GALA**  
HOMES

**Pisces**  
TWO STOREY

## Floor plan



GROUND FLOOR

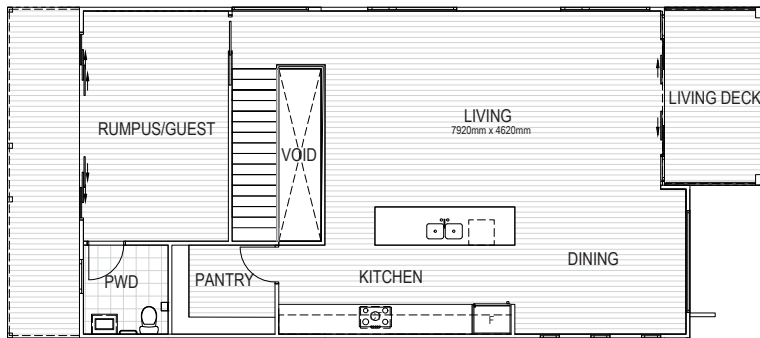

FIRST FLOOR

### GROUND FLOOR

Master Bedroom	3.34m x 3.71m
Master Ensuite	1.40m x 2.62m
Bathroom	1.80m x 2.62m
Bathroom	3.00m x 2.41m
Bedroom 2	3.42m x 3.21m
Bedroom 3	3.42m x 3.21m
Laundry	1.50m x 2.62m
Entry Foyer	2.10m x 2.36m
Garage	6.33m x 5.50m

### FIRST FLOOR

Dining Room	4.03m x 3.42m
Living Room	7.92m x 4.62m
Kitchen	5.57m x 3.00m
Pantry	2.43m x 2.10m
Powder Room	2.00m x 2.10m
Rumpus / Guest	3.42m x 5.43m

### EXTERNAL

Deck 1	2.10m x 1.50m
Deck 2	1.50m x 1.20m
Deck 3	1.70m x 7.80m
Living Deck	2.40m x 4.20m
Deck 4	1.70m x 7.80m

## Key features

HOUSE TYPE	BEDS	BATHS	GARAGE	LIVING AREAS	DECK	ALFRESCO	THEATRE	WIDTH m	DEPTH m	SIZE m <sup>2</sup>
TWO STOREY	3	2.5	2	1	3	4	1	9.18	17.96	256.00

- 9ft (2700mm) Ceilings
- 8ft (2400mm) high Doors & Windows
- European Appliances
- Luxury Fixtures & Fittings
- Stone Benchtops
- Custom Joinery with Soft Closing Doors & Draws
- Robe, Store & Linen Joinery
- Walk in Pantry
- Timber Staircase
- Carpet to the Ground Floor Bedrooms
- 600x600 Tiles to the Ground Floor Entry & Wet Areas
- T&G Floors to the First Floor
- External Timber to the Decks
- 6 Star Energy Rating
- T2 Structural Framing

Whilst all details have been carefully prepared and are believed to be correct, no warranty can be given either expressly or implied by the vendors or their agents. Intending purchasers must rely on their own enquiries. Photographs and illustrations are for presentation purposes only and are indicative only. They should not be relied upon as an accurate representation of the final product. Correct at time of print. Specification may change at anytime.